

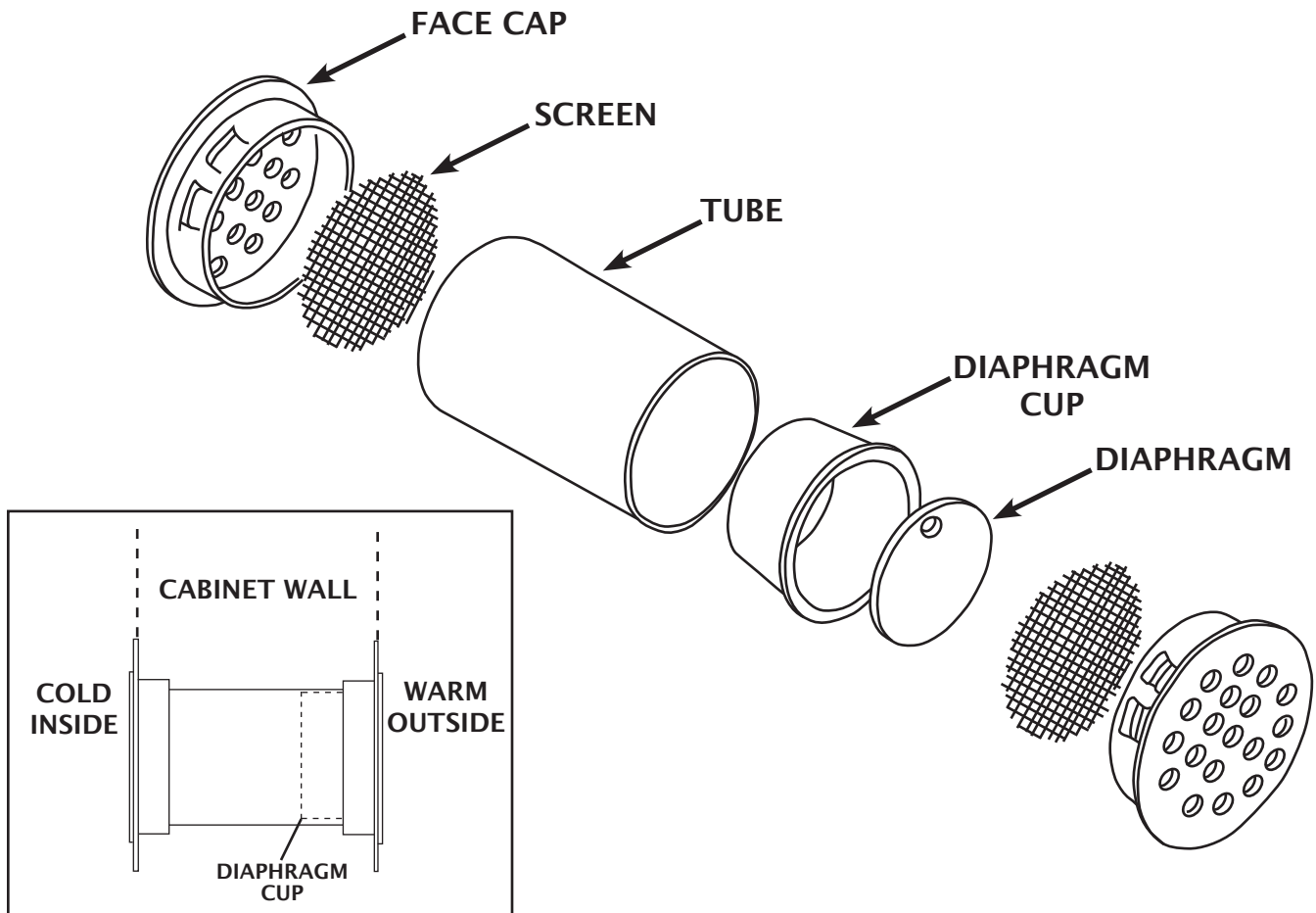

Refrigeration Hardware

R88-1000 MICRO-MINI VENT PORT INSTALLATION INSTRUCTIONS

(Standard-Keil #2788 Series)



1. Drill 2" diameter hole thru wall of unit.
2. Cut tubing (if necessary) 1/8" shorter than wall thickness.
3. Insert screens into face caps.
4. Insert diaphragm cup flush into face cap.
5. Insert tube into remaining face cap.
6. Install face cap with tube into wall from inside of unit.
7. Snap face cap with diaphragm cup into wall on outside of unit.

Note: Hinged portion of silicone diaphragm should be oriented towards top.

Component Hardware Group, Inc.

1890 Swarthmore Avenue, PO Box 2020, Lakewood, NJ 08701 • Tel. 800-526-3694 • 732-363-4700 • Fax 732-364-8110

www.keilhardware.com

#R88-X007 3/11