

PROJECT NAME: _____

LOCATION: _____

SPECIFIER ITEM NO. _____ **QTY:** _____

COMPONENT HARDWARE PART NO. _____

Component Hardware® 1-5/8" x 5-1/4" H
Stainless Steel Tubular Shelf Support With
Two Set Screws

A24-0207-C

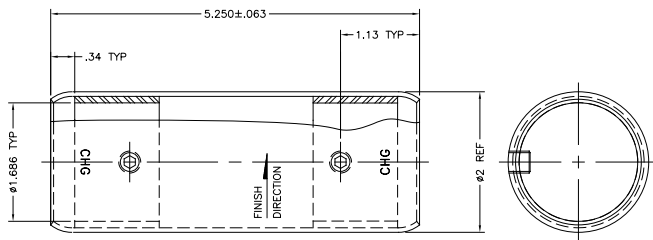

Dimensions shown in inches (mm) are for reference only and are subject to change.

1-5/8" x 5-1/4" H Stainless Steel Tubular Shelf Support With Two Set Screws

Heavy Duty Construction

- 2" OD 16-gauge stainless steel construction
- 5-1/4" OA height
- Satin finish
- Accepts 1-5/8" OD tubing
- Provided with two locking set screws to assure secure assembly
- Can be used as adjustable pot rack band support or corner support for shelving
- Permits knock down shipping of equipment to reduce freight costs

Specifications

Stainless steel tubular shelf support to be Component Hardware A24-0207-C. Shelf support to be 5-1/4" high with two set screws.