

Component Hardware® 2" Square Stainless Steel Clad Zinc Die Cast Adjustable Flanged Foot Insert With Mounting Holes

A15-0854-C

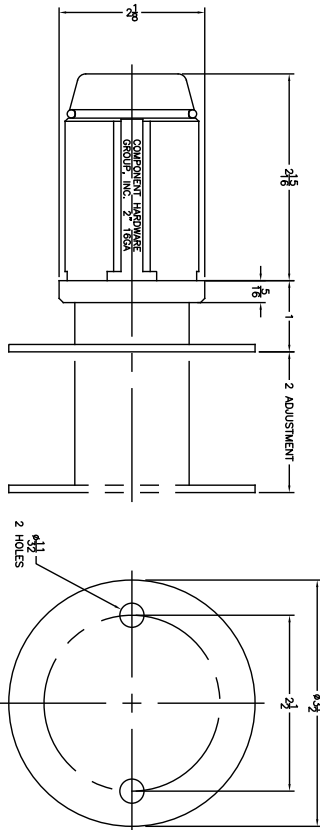

Dimensions shown in inches (mm) are for reference only and are subject to change.

2" Square Stainless Steel Clad Zinc Die Cast Adjustable Flanged Foot Insert With Mounting Holes

Heavy Duty Construction

- For use with 2" x 2" 16-gauge square tubing
- Stainless steel clad zinc die cast construction
- 1" height in fully closed position
- Adjustable toe permits leveling of equipment up to 2"
- 3-1/2" OD 12-gauge stainless steel flanged toe with two 11/32" mounting holes spaced 2-1/2" OC permits secure fastening to the floor
- 2,300 lbs static load capacity

Specifications

Stainless steel clad zinc die cast adjustable flanged foot insert with mounting holes to be Component Hardware A15-0854-C. Insert to be 1" high and adjustable to 2" for leveling on job site.